

# TREATMENT PERFORMANCE RESULTS

**Burke Wastewater**  
Corandulla; Co. Galway, Ireland

**Tpw Systems Ltd.**  
Screen, Co. Wexford, Ireland

**EN 12566-3**

Results corresponding to EN 12566-3 and S.R. 66  
PIA-SR66-1703-1027

**Small wastewater treatment system**  
**Burke Wastewater / Tpw EUROTANK**  
Biological Aeration Filter (BAF)

Nominal organic daily load	0.33 kg/d		
Nominal hydraulic daily load	0.90 m <sup>3</sup> /d		
Material	Concrete		
Watertightness	Pass		
Crushing resistance (calculation)	Pass (also wet conditions)		
Durability	Pass		
Treatment efficiency (nominal sequences)		Efficiency	Effluent
	COD	94.0 %	51 mg/l
	BOD <sub>5</sub>	96.1 %	12 mg/l
	NH <sub>4</sub> -N*	99.1 %	0.3 mg/l
	SS	96.2 %	15 mg/l
Number of desludging	Not more than once		
Electrical consumption	1.3 kWh/d		

\*determined for temperatures  $\geq 12^{\circ}\text{C}$  in the bioreactor

Performance tested by:

**PIA – Prüfinstitut für Abwassertechnik GmbH**  
(PIA GmbH)  
Hergenrather Weg 30  
52074 Aachen, Germany

This document replaces neither the declaration  
of performance nor the CE marking.



Notified Body  
No.: 1739



Certified according to  
ISO 9001:2008





Prüfinstitut für Abwassertechnik GmbH  
*[Signature]*  
geprüft - tested - testé

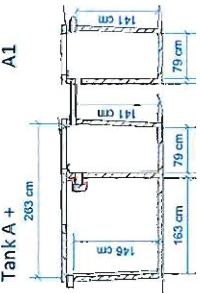
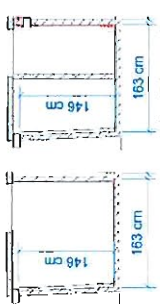
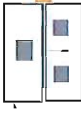

Elmar Lancé

May 2017

## EUROTANK range and its referring test reports:

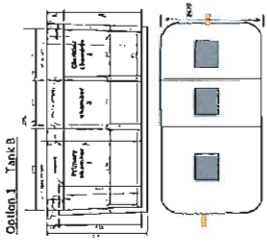
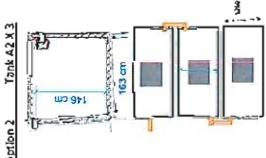
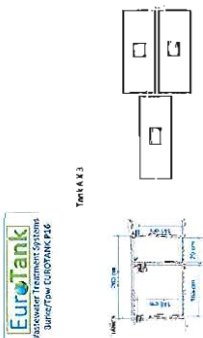
Name of the model and/or population equivalent (PE)	Drawing of model of the range	Watertightness (EN 12566-3 Annex A)	Treatment Efficiency (EN 12566-3 Annex B)	Structural Behaviour (EN 12566-3 Annex C)	Durability
Initial Type Test (ITT) 6.1		Pass  PIA2016-WD-1604-1051.01	Pass  PIA2017-285B49	Pass  For wet ground conditions also, 1.00 m installation depth from inlet invert.	Pass  PIA2016-DH-1604-1051.01
6.2		Pass  PIA2016-WD-1604-1051.01	Pass  Range conformity check according to S.R. 66:2015	Pass  For wet ground conditions also, 1.00 m installation depth from inlet invert.	Pass  PIA2016-DH-1604-1051.01
9	  	Pass  PIA2016-WD-1604-1051.01	Pass  Range conformity check according to S.R. 66:2015	Pass  For wet ground conditions also, 1.00 m installation depth from inlet invert.	Pass  PIA2016-DH-1604-1051.01

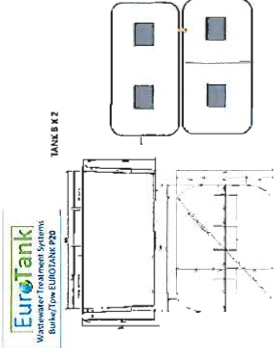
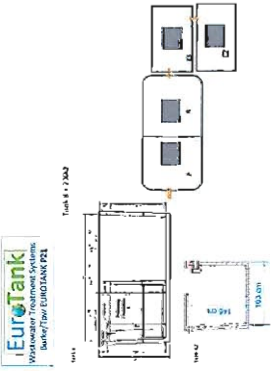
Name of the model and/or population equivalent (PE)	Drawing of model of the range	Watertightness (EN 12566-3 Annex A)	Treatment Efficiency (EN 12566-3 Annex B)	Structural Behaviour (EN 12566-3 Annex C)	Durability
11.1	 <p>Option 1 Tank B</p>	<p>Pass</p> <p>PIA2016-WD-1604-1051.01</p>	<p>Pass</p> <p>Range conformity check according to S.R. 66:2015</p>	<p>Pass</p> <p>PIA2016-ST-CAL-1604-1051.01</p> <p>For wet ground conditions also, 1.00 m installation depth from inlet invert.</p>	<p>Pass</p> <p>PIA2016-DH-1604-1051.01</p>
11.2	 <p>Option 2 Tank A 2 x 3</p>	<p>Pass</p> <p>PIA2016-WD-1604-1051.01</p>	<p>Pass</p> <p>Range conformity check according to S.R. 66:2015</p>	<p>Pass</p> <p>For wet ground conditions also, 1.00 m installation depth from inlet invert.</p>	<p>Pass</p> <p>PIA2016-DH-1604-1051.01</p>
16	 <p>Tank A X3</p> <p>EuroTank Produktion für Sauerstoff- und Sauerstoff- und Sauerstoff- und</p>	<p>Pass</p> <p>PIA2016-WD-1604-1051.01</p>	<p>Pass</p> <p>Range conformity check according to S.R. 66:2015</p>	<p>Pass</p> <p>For wet ground conditions also, 1.00 m installation depth from inlet invert.</p>	<p>Pass</p> <p>PIA2016-DH-1604-1051.01</p>

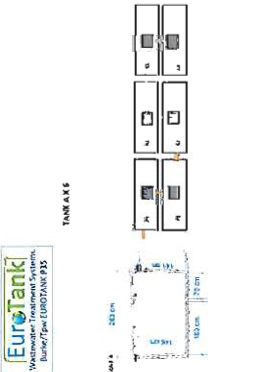
Name of the model and/or population equivalent (PE)	Drawing of model of the range	Watertightness (EN 12566-3 Annex A)	Treatment Efficiency (EN 12566-3 Annex B)	Structural Behaviour (EN 12566-3 Annex C)	Durability
20		Pass  PIA2016-WD-1604-1051.01	Pass  Range conformity check according to S.R. 66:2015	Pass  For wet ground conditions also, 1.00 m installation depth from inlet invert.	Pass  PIA2016-DH-1604-1051.01
21		Pass  PIA2016-WD-1604-1051.01	Pass  Range conformity check according to S.R. 66:2015	Pass  For wet ground conditions also, 1.00 m installation depth from inlet invert.	Pass  PIA2016-DH-1604-1051.01
24		Pass  PIA2016-WD-1604-1051.01	Pass  Range conformity check according to S.R. 66:2015	Pass  For wet ground conditions also, 1.00 m installation depth from inlet invert.	Pass  PIA2016-DH-1604-1051.01
35		Pass  PIA2016-WD-1604-1051.01	Pass  Range conformity check according to S.R. 66:2015	Pass  For wet ground conditions also, 1.00 m installation depth from inlet invert.	Pass  PIA2016-DH-1604-1051.01

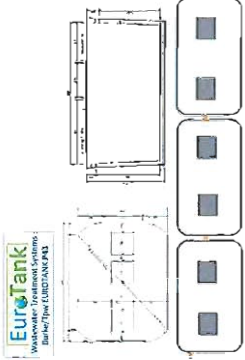
Name of the model and/or population equivalent (PE)	Drawing of model of the range	Watertightness (EN 12566-3 Annex A)	Treatment Efficiency (EN 12566-3 Annex B)	Structural Behaviour (EN 12566-3 Annex C)	Durability
43		<p>Pass</p> <p>PIA2016-WD-1604-1051.01</p>	<p>Pass</p> <p>Range conformity check according to S.R. 66:2015</p>	<p>Pass</p> <p>For wet ground conditions also, 1.00 m installation depth from inlet invert.</p>	<p>Pass</p> <p>PIA2016-DH-1604-1051.01</p>

**EuroTank**  
Wastewater Treatment Systems  
Burke/7pw EUROTANK P6

Option 1

Tank A + A1

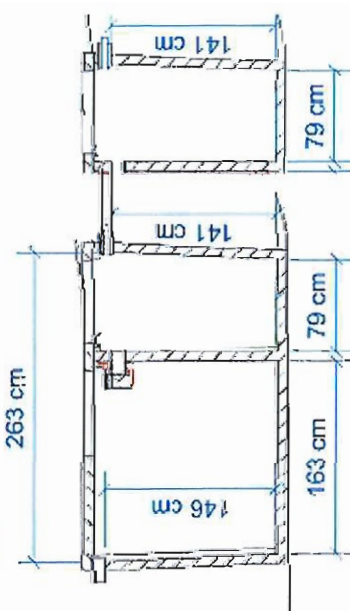

Option 2

Tank A2 + A2

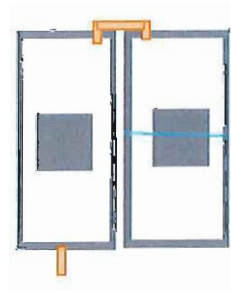
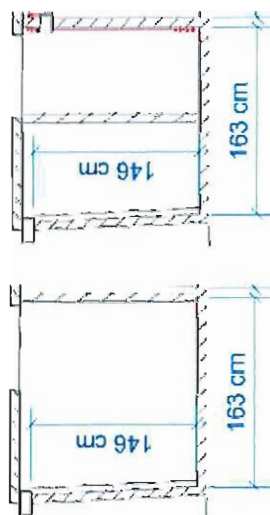



Tank A

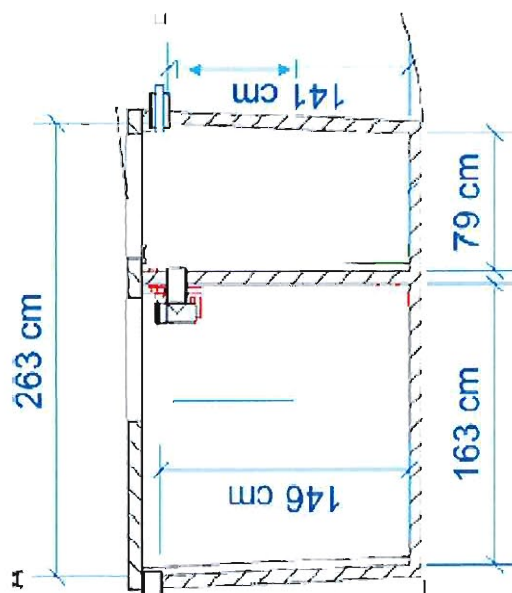

Tank A X 2

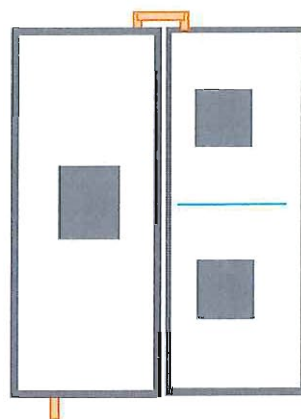

# EuroTank

Wastewater Treatment Systems  
Burke/Tpw EUROTANK P11

Option 1 Tank B

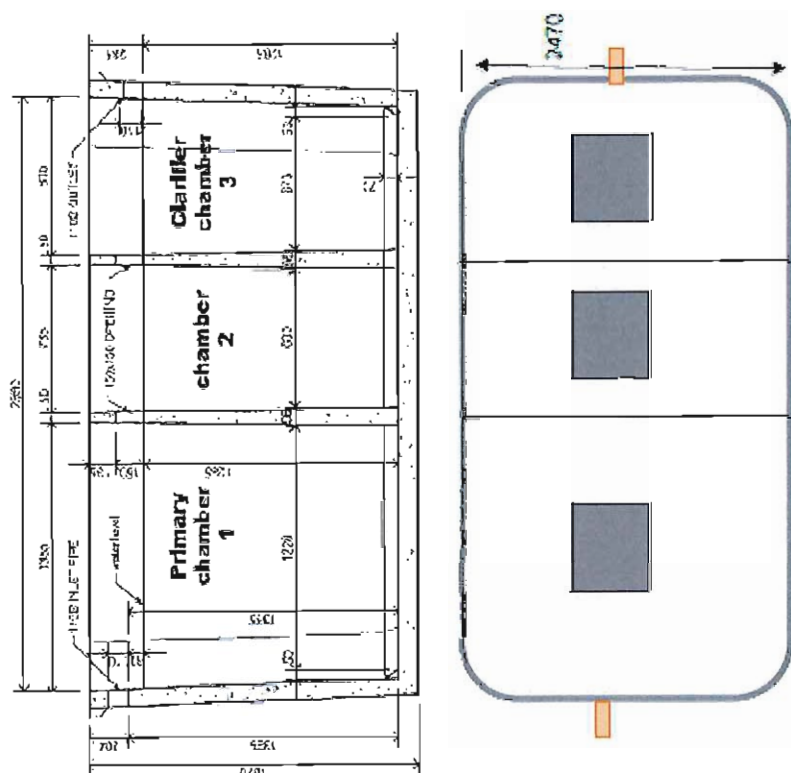

Option 2 Tank A2 X 3

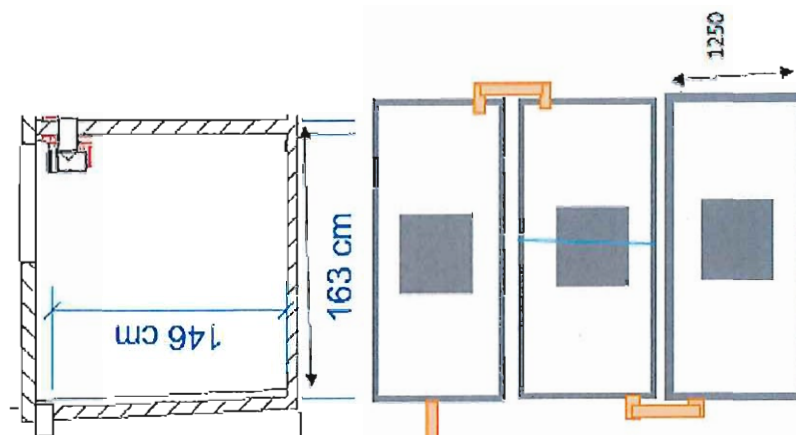

**EuroTank**  
 Wastewater Treatment Systems  
 Burke/Tpw EUROTANK P16

Tank A X 3

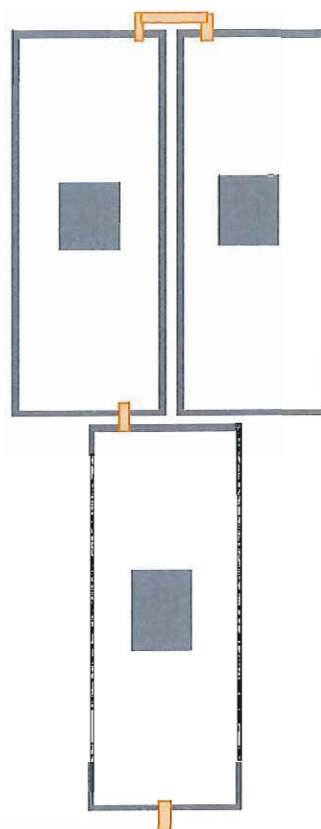
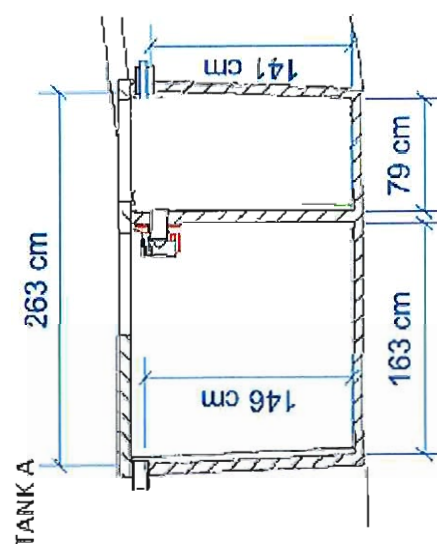

## TANK B X2

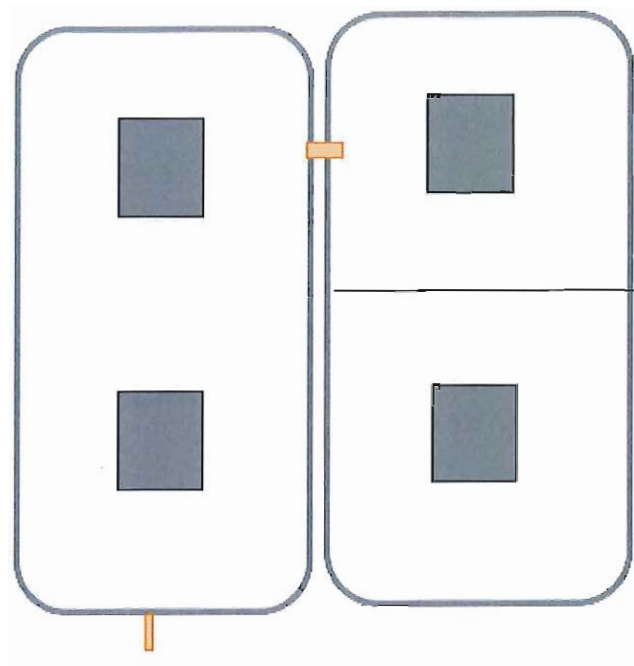
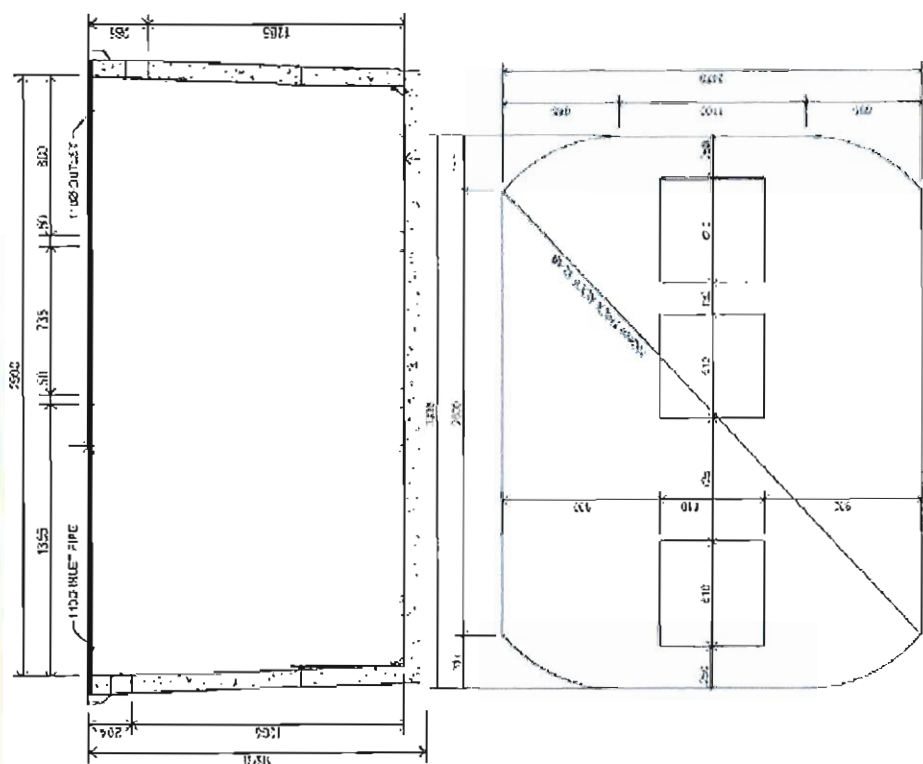



**EuroTank**  
 Wastewater Treatment Systems  
 Burke/TPW EUROTANK P24

**Option 1 Tank A2 x 6**

TANK A2

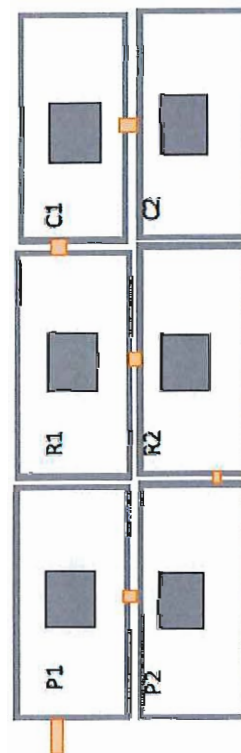
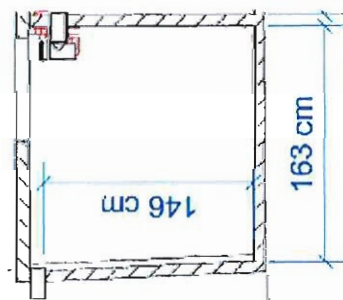

**Option 2 Tank C + 2 X A2**

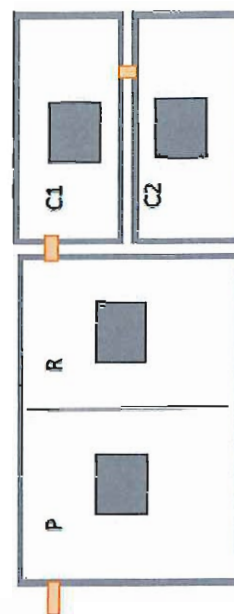
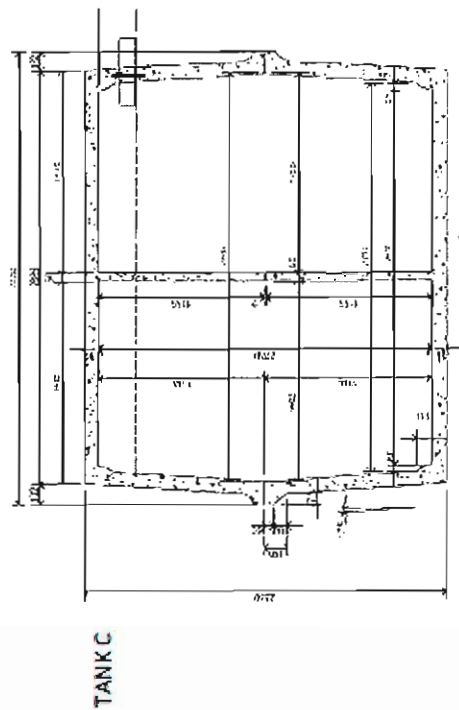



### Option 1 Tank A2 x 6

TANK A2

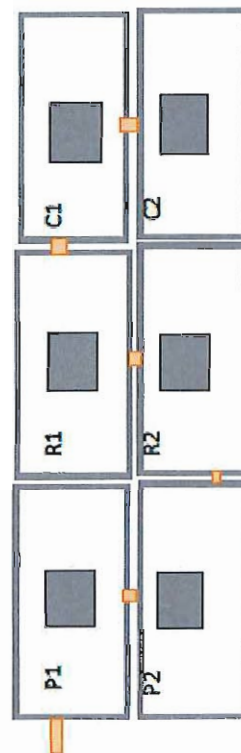
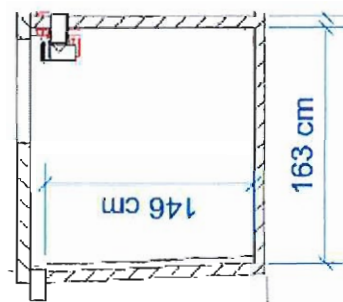

### Option 2 Tank C + 2 X A2

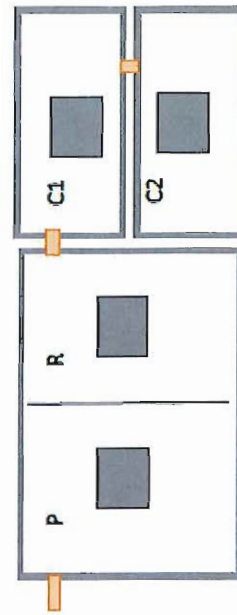
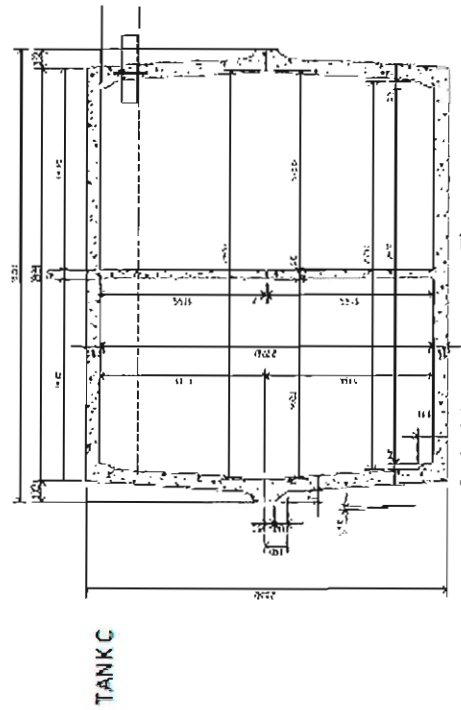



## TANK A X 6

